

WICKEN PARISH NEIGHBOURHOOD PLAN

Dear Resident of Wicken, Upware, and Padney,

Wicken Parish Council is developing a Neighbourhood Plan for the Parish. A map of the designated Neighbourhood Plan Area is on page 2. To help shape the plan's direction, we invite you and your household to complete the attached questionnaire and share your views.



What is a Neighbourhood Plan?

A Neighbourhood Plan gives local communities a say in how their area develops. Covering at least a 10-year period, it enables residents to:

- Create a shared vision for the Parish
- Decide where new housing and other developments should be located
- Influence the type and style of development
- Identify and protect valued green spaces and community assets

Why Do We Need One?

District Councils must maintain up-to-date Local Plans to guide development and conservation. East Cambridgeshire's current Local Plan is 10 years old and lacks clear guidance on long-term housing growth, making the Parish vulnerable to speculative development.

By creating a Neighbourhood Plan, we can influence where future development should or shouldn't occur and highlight areas that deserve protection or improvement. With expected housing growth over the next 15 years in line with the government's housing growth, the Plan offers a chance to shape this change rather than have decisions made without local input.

Once adopted, the Neighbourhood Plan must be considered by the District Council (or whatever unitary authority emerges), when deciding on planning applications, alongside the Local Plan and national policy.

A Working Group of residents and councillors is helping to prepare the Plan. Many of you shared ideas at our open day in March. Based on that feedback, we are now seeking your views on specific topics to include in the Plan.

Completing the Survey

Please return the completed survey to the collection box at Wicken Village Hall or the following addresses in Wicken:

4 Butts Lane
42 Chapel Lane
26 Church Road
Paddock House, 6a Lower Road

Alternatively, you can complete it online at:

<https://www.smartsurvey.co.uk/s/Wicken-Survey/>

or scan the QR code using a mobile device.



Completed surveys must be received by 15 September 2025

Each household has received one copy. Anyone aged 16 or over who would like to fill in their own copy can download it from <https://wicken-village.org.uk/> contact Bill Pepper 07971 885639 or Rachel James 07772 319821 or access it using the link above.

Questions 30-36 should be completed once per household only.

Need Help?

If you need help completing the survey, please contact:

Bill Pepper 07971 885639 or Rachel James 07772 319821



Wicken Parish

Neighbourhood Plan Topics

1. The typical topics covered in a neighbourhood plan are:

- ☐ Residential Development
- ☐ Building Design
- ☐ Natural Environment
- ☐ Communication
- ☐ Transport
- ☐ Traffic
- ☐ Services
- ☐ Amenities

Please rank these in order of most importance to you starting with 1 as the most important and 8 as the least important (please rank all).

Living in Wicken

2. Feedback from the residents suggests that the following things make Wicken Parish an attractive place to live: do you agree?

Please tick only one box per row

	Strongly Agree	Agree	Neutral	Disagree	Strongly Disagree
a safe place to live	<input type="checkbox"/>	<input type="checkbox"/>	<input type="checkbox"/>	<input type="checkbox"/>	<input type="checkbox"/>
friendly and welcoming	<input type="checkbox"/>	<input type="checkbox"/>	<input type="checkbox"/>	<input type="checkbox"/>	<input type="checkbox"/>
well located for commuting	<input type="checkbox"/>	<input type="checkbox"/>	<input type="checkbox"/>	<input type="checkbox"/>	<input type="checkbox"/>
has a good community spirit	<input type="checkbox"/>	<input type="checkbox"/>	<input type="checkbox"/>	<input type="checkbox"/>	<input type="checkbox"/>
has good community involvement	<input type="checkbox"/>	<input type="checkbox"/>	<input type="checkbox"/>	<input type="checkbox"/>	<input type="checkbox"/>
offers good opportunities to interact with nature	<input type="checkbox"/>	<input type="checkbox"/>	<input type="checkbox"/>	<input type="checkbox"/>	<input type="checkbox"/>
offers an abundance of good walking paths	<input type="checkbox"/>	<input type="checkbox"/>	<input type="checkbox"/>	<input type="checkbox"/>	<input type="checkbox"/>
offers a range of attractive and interesting historical buildings	<input type="checkbox"/>	<input type="checkbox"/>	<input type="checkbox"/>	<input type="checkbox"/>	<input type="checkbox"/>
offers a cosy, small village feel	<input type="checkbox"/>	<input type="checkbox"/>	<input type="checkbox"/>	<input type="checkbox"/>	<input type="checkbox"/>
offers bridleways	<input type="checkbox"/>	<input type="checkbox"/>	<input type="checkbox"/>	<input type="checkbox"/>	<input type="checkbox"/>
offers public footpaths and byways	<input type="checkbox"/>	<input type="checkbox"/>	<input type="checkbox"/>	<input type="checkbox"/>	<input type="checkbox"/>
offers cycle paths	<input type="checkbox"/>	<input type="checkbox"/>	<input type="checkbox"/>	<input type="checkbox"/>	<input type="checkbox"/>
benefits from open spaces and greens within the Parish	<input type="checkbox"/>	<input type="checkbox"/>	<input type="checkbox"/>	<input type="checkbox"/>	<input type="checkbox"/>

Please add any other things that make Wicken Parish an attractive place to live

3. Residents have suggested that the following are areas of concern or need improvement. Do you agree or disagree?

Please tick only one box per row

	Strongly Agree	Agree	Neutral	Disagree	Strongly Disagree
Limited transportation services	<input type="checkbox"/>	<input type="checkbox"/>	<input type="checkbox"/>	<input type="checkbox"/>	<input type="checkbox"/>
School places	<input type="checkbox"/>	<input type="checkbox"/>	<input type="checkbox"/>	<input type="checkbox"/>	<input type="checkbox"/>
Lack of off-road parking in the Parish	<input type="checkbox"/>	<input type="checkbox"/>	<input type="checkbox"/>	<input type="checkbox"/>	<input type="checkbox"/>
Lack of a Parish shop	<input type="checkbox"/>	<input type="checkbox"/>	<input type="checkbox"/>	<input type="checkbox"/>	<input type="checkbox"/>
Proposed battery storage facility	<input type="checkbox"/>	<input type="checkbox"/>	<input type="checkbox"/>	<input type="checkbox"/>	<input type="checkbox"/>
Potential loss of green spaces due to housing development (note that designated public spaces such as the greens, allotments and recreational grounds are protected)	<input type="checkbox"/>	<input type="checkbox"/>	<input type="checkbox"/>	<input type="checkbox"/>	<input type="checkbox"/>
Water pressure	<input type="checkbox"/>	<input type="checkbox"/>	<input type="checkbox"/>	<input type="checkbox"/>	<input type="checkbox"/>
Sewage	<input type="checkbox"/>	<input type="checkbox"/>	<input type="checkbox"/>	<input type="checkbox"/>	<input type="checkbox"/>
Unreliable broadband	<input type="checkbox"/>	<input type="checkbox"/>	<input type="checkbox"/>	<input type="checkbox"/>	<input type="checkbox"/>

Are there other issues about living in Wicken that cause you concern?

4. How would you like to see Wicken in 20 years?

Please tick only one box per row

	Strongly Agree	Agree	Neutral	Disagree	Strongly Disagree
Our green spaces have been retained	<input type="checkbox"/>	<input type="checkbox"/>	<input type="checkbox"/>	<input type="checkbox"/>	<input type="checkbox"/>
New housing is of high-quality design	<input type="checkbox"/>	<input type="checkbox"/>	<input type="checkbox"/>	<input type="checkbox"/>	<input type="checkbox"/>
New housing preserves space between houses	<input type="checkbox"/>	<input type="checkbox"/>	<input type="checkbox"/>	<input type="checkbox"/>	<input type="checkbox"/>
The Parish has ample off-street parking for residents and visitors	<input type="checkbox"/>	<input type="checkbox"/>	<input type="checkbox"/>	<input type="checkbox"/>	<input type="checkbox"/>
Wicken Parish is a safe place for people and pets	<input type="checkbox"/>	<input type="checkbox"/>	<input type="checkbox"/>	<input type="checkbox"/>	<input type="checkbox"/>
Wicken Parish has retained its small village charm	<input type="checkbox"/>	<input type="checkbox"/>	<input type="checkbox"/>	<input type="checkbox"/>	<input type="checkbox"/>
Wicken Parish is a good place for wildlife as well as people	<input type="checkbox"/>	<input type="checkbox"/>	<input type="checkbox"/>	<input type="checkbox"/>	<input type="checkbox"/>

5. Do you have any other comments about living in Wicken Parish?

Comments

Residential Development

In the 20 years to 2021, 45 new homes were built in the parish. This represents a growth of 13%.

We know that Government growth forecasts mean that East Cambridgeshire has to deliver 683 new homes a year, a 64% increase when compared with the annual average over the 20 years to 2021.

If a similar proportion of this growth were to take place in Wicken, around 60 additional homes would be needed between 2024 and 2040, although there were already planning permissions for 41 in the parish in 2024 that had yet to be built.

In developments of 10 or more homes, a minimum of 30% have to be "affordable" homes.

6. If additional housing were to be developed in Wicken Parish, what would be acceptable to you?

*In developments of 10 or more homes, a minimum of 30% have to be "affordable" homes for those that can't afford to pay open market prices.

Please tick all that apply

- ☐ Developments of more than 10 houses which include affordable housing
- ☐ Small groups of less than 10 houses which do NOT have to include affordable housing
- ☐ Infill plots of one or two houses including self-build homes
- ☐ No preference/ don't know

7. If additional housing were to be developed in Wicken Parish, which of the following do you think should be built between now and the next 15 years?

Please tick all that apply

- ☐ Social rented housing (housing association or local authority)
- ☐ Shared ownership housing
- ☐ Rented privately on open market
- ☐ Owner occupied
- ☐ No preference/ don't know

8. Do you agree or disagree that future homes built in Wicken Parish should be:

Please tick only one box per row

	Strongly Agree	Agree	Neutral	Disagree	Strongly Disagree
Suitable for first time buyers	<input type="checkbox"/>	<input type="checkbox"/>	<input type="checkbox"/>	<input type="checkbox"/>	<input type="checkbox"/>
For people with a local connection	<input type="checkbox"/>	<input type="checkbox"/>	<input type="checkbox"/>	<input type="checkbox"/>	<input type="checkbox"/>
Suitable for downsizing	<input type="checkbox"/>	<input type="checkbox"/>	<input type="checkbox"/>	<input type="checkbox"/>	<input type="checkbox"/>
Suitable for the elderly	<input type="checkbox"/>	<input type="checkbox"/>	<input type="checkbox"/>	<input type="checkbox"/>	<input type="checkbox"/>
Built to the highest environmental standards	<input type="checkbox"/>	<input type="checkbox"/>	<input type="checkbox"/>	<input type="checkbox"/>	<input type="checkbox"/>
Designed to fit with the local character of the village	<input type="checkbox"/>	<input type="checkbox"/>	<input type="checkbox"/>	<input type="checkbox"/>	<input type="checkbox"/>
Adaptable to meet lifetime needs	<input type="checkbox"/>	<input type="checkbox"/>	<input type="checkbox"/>	<input type="checkbox"/>	<input type="checkbox"/>

9. What type of homes do you think should be built?:

Please tick only one box per row

	Strongly Agree	Agree	Neutral	Disagree	Strongly Disagree
1 bedroom homes	<input type="checkbox"/>	<input type="checkbox"/>	<input type="checkbox"/>	<input type="checkbox"/>	<input type="checkbox"/>
2 bedroom homes	<input type="checkbox"/>	<input type="checkbox"/>	<input type="checkbox"/>	<input type="checkbox"/>	<input type="checkbox"/>
3 bedroom homes	<input type="checkbox"/>	<input type="checkbox"/>	<input type="checkbox"/>	<input type="checkbox"/>	<input type="checkbox"/>
4 or more bedroom homes	<input type="checkbox"/>	<input type="checkbox"/>	<input type="checkbox"/>	<input type="checkbox"/>	<input type="checkbox"/>
Small bungalows (1 or 2 bedrooms)	<input type="checkbox"/>	<input type="checkbox"/>	<input type="checkbox"/>	<input type="checkbox"/>	<input type="checkbox"/>
Larger bungalows (3+ bedrooms)	<input type="checkbox"/>	<input type="checkbox"/>	<input type="checkbox"/>	<input type="checkbox"/>	<input type="checkbox"/>

10. Do you have any other comments about residential development?

Comments

Location of future homes

The current Local Plan designates a “Development Envelope” around the main centre of the village and for Upware, as illustrated.

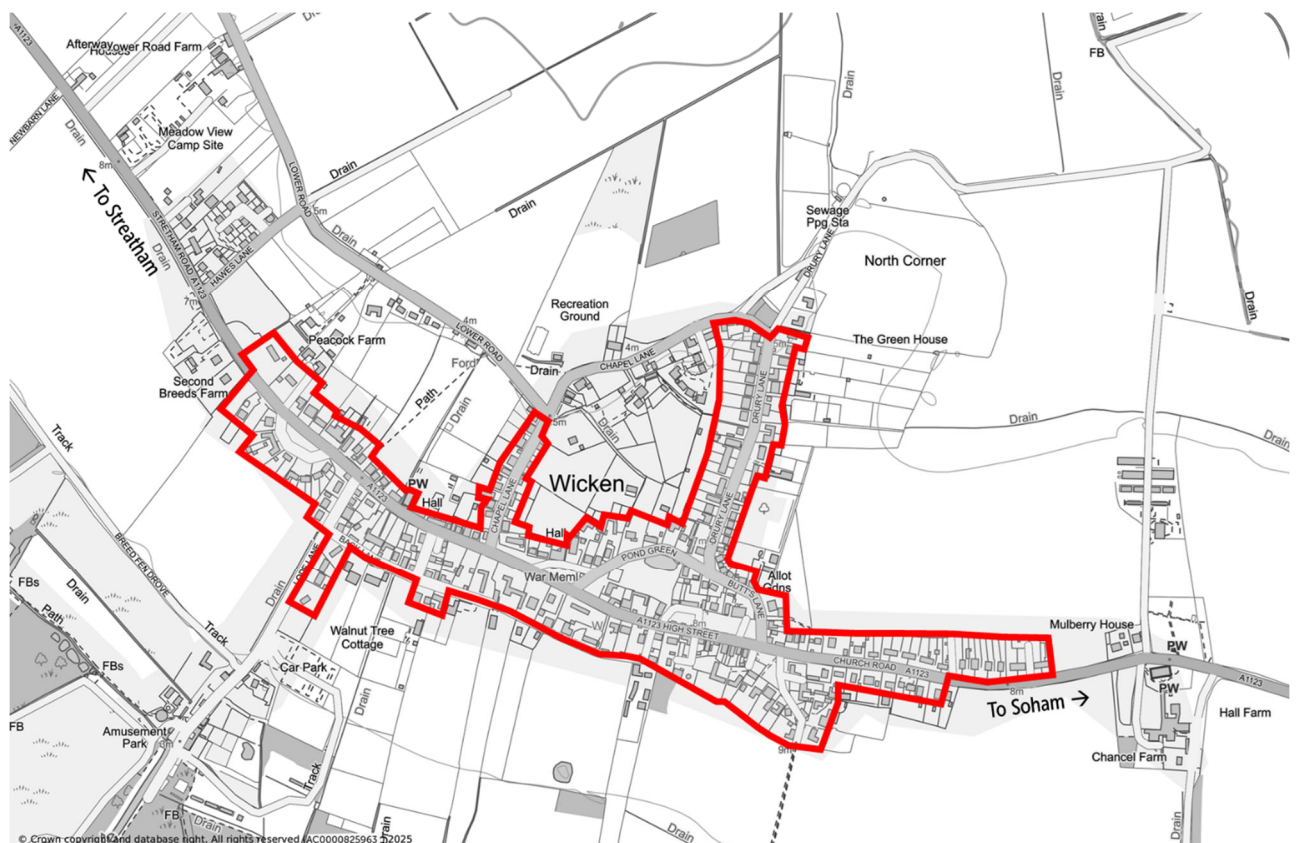

Wicken Development Envelope

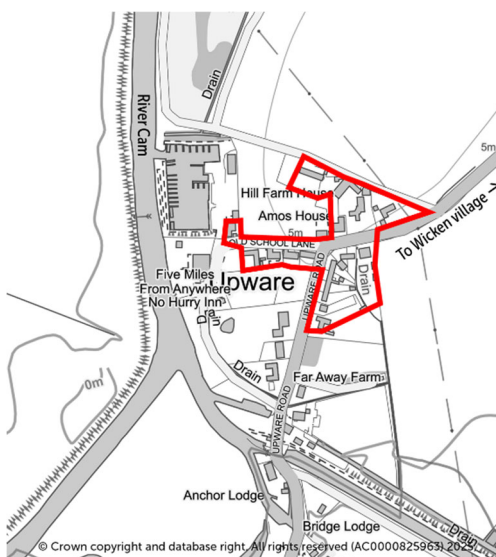

Upware Development Envelope

The Development Envelope is a planning tool that helps to manage the spread of towns and villages into the open countryside. Where they are defined in a local or neighbourhood plan, development proposals within them would normally be acceptable, subject to complying with other planning policies. Proposals outside a Development Envelope are only supported in specific or exceptional circumstances, such as essential dwellings for rural workers or affordable housing.

Preparing the Neighbourhood Plan provides a chance to update the Development Envelope.

To meet future housing needs, some land outside the current Development Envelope may need to be used.

Residents will be invited to give feedback after potential development sites are identified.

11. Do you agree that the following factors should be taken into account when identifying potential sites?

Please tick only one box per row

	Strongly Agree	Agree	Neutral	Disagree	Strongly Disagree
Avoiding impact on areas important to wildlife	<input type="checkbox"/>	<input type="checkbox"/>	<input type="checkbox"/>	<input type="checkbox"/>	<input type="checkbox"/>
Avoiding impact on historic buildings	<input type="checkbox"/>	<input type="checkbox"/>	<input type="checkbox"/>	<input type="checkbox"/>	<input type="checkbox"/>
Residents should have good pedestrian links to the village centre	<input type="checkbox"/>	<input type="checkbox"/>	<input type="checkbox"/>	<input type="checkbox"/>	<input type="checkbox"/>
Development should not impact on important views	<input type="checkbox"/>	<input type="checkbox"/>	<input type="checkbox"/>	<input type="checkbox"/>	<input type="checkbox"/>
Development should not impact on footpaths, bridleways or cycle paths	<input type="checkbox"/>	<input type="checkbox"/>	<input type="checkbox"/>	<input type="checkbox"/>	<input type="checkbox"/>
Development should have good vehicular access	<input type="checkbox"/>	<input type="checkbox"/>	<input type="checkbox"/>	<input type="checkbox"/>	<input type="checkbox"/>
Development should not impact on sewage infrastructure	<input type="checkbox"/>	<input type="checkbox"/>	<input type="checkbox"/>	<input type="checkbox"/>	<input type="checkbox"/>

Building Design

Much of Wicken Parish's charm comes from its mix of building styles and materials and its relatively open layout. We hope to have design guidance in the Plan and to make sure that buildings are designed to high standards.

12. How important to you are the following?

Please tick only one box per row

	Very Important	Important	Neutral	Not Important	Don't know
Use of local building materials	<input type="checkbox"/>	<input type="checkbox"/>	<input type="checkbox"/>	<input type="checkbox"/>	<input type="checkbox"/>
Use of local traditional building styles	<input type="checkbox"/>	<input type="checkbox"/>	<input type="checkbox"/>	<input type="checkbox"/>	<input type="checkbox"/>
Use modern design	<input type="checkbox"/>	<input type="checkbox"/>	<input type="checkbox"/>	<input type="checkbox"/>	<input type="checkbox"/>
Reflecting building densities of the locality	<input type="checkbox"/>	<input type="checkbox"/>	<input type="checkbox"/>	<input type="checkbox"/>	<input type="checkbox"/>
Incorporation of water saving measures	<input type="checkbox"/>	<input type="checkbox"/>	<input type="checkbox"/>	<input type="checkbox"/>	<input type="checkbox"/>
Incorporation of energy saving measures	<input type="checkbox"/>	<input type="checkbox"/>	<input type="checkbox"/>	<input type="checkbox"/>	<input type="checkbox"/>
Provide sufficient on-site parking	<input type="checkbox"/>	<input type="checkbox"/>	<input type="checkbox"/>	<input type="checkbox"/>	<input type="checkbox"/>
Incorporate covered storage for cycles	<input type="checkbox"/>	<input type="checkbox"/>	<input type="checkbox"/>	<input type="checkbox"/>	<input type="checkbox"/>
Incorporation of adequate storage for wheelie bins	<input type="checkbox"/>	<input type="checkbox"/>	<input type="checkbox"/>	<input type="checkbox"/>	<input type="checkbox"/>
Incorporation renewable energy features	<input type="checkbox"/>	<input type="checkbox"/>	<input type="checkbox"/>	<input type="checkbox"/>	<input type="checkbox"/>
Provision of electric vehicle charging points	<input type="checkbox"/>	<input type="checkbox"/>	<input type="checkbox"/>	<input type="checkbox"/>	<input type="checkbox"/>

Anything else? Please tell us:

Our Natural Environment

We live in a unique flat open landscape with few trees containing a high density of sites of historic and ecological significance. Wicken Fen is of international significance and areas around the River Cam are of national importance.

The south of our Parish is primarily in the National Trust's Vision Area reflecting its national and regional value for conservation and recreation.

The questions in this section are based on themes expressed by those that attended our Neighbourhood Plan launch event and at previous consultations about the importance of preserving the unique character of our Parish and its surroundings.

The Neighbourhood Plan could provide an additional layer of protection for those aspects of our landscape that we cherish.

13. How important is it to you to minimise the effect of development on the following features?

Please tick only one box per row

	Very Important	Important	Neutral	Not Important	Don't know
The village greens	<input type="checkbox"/>	<input type="checkbox"/>	<input type="checkbox"/>	<input type="checkbox"/>	<input type="checkbox"/>
Millenium Wood (at the bottom of the Rec)	<input type="checkbox"/>	<input type="checkbox"/>	<input type="checkbox"/>	<input type="checkbox"/>	<input type="checkbox"/>
The edge of the fens	<input type="checkbox"/>	<input type="checkbox"/>	<input type="checkbox"/>	<input type="checkbox"/>	<input type="checkbox"/>
Hedgerows	<input type="checkbox"/>	<input type="checkbox"/>	<input type="checkbox"/>	<input type="checkbox"/>	<input type="checkbox"/>
Mature trees	<input type="checkbox"/>	<input type="checkbox"/>	<input type="checkbox"/>	<input type="checkbox"/>	<input type="checkbox"/>
Green spaces between existing housing	<input type="checkbox"/>	<input type="checkbox"/>	<input type="checkbox"/>	<input type="checkbox"/>	<input type="checkbox"/>
Anything else? Please tell us:					

14. How important to you are the views approaching and leaving Wicken and from within the Parish itself?

Please tick only one box

☐ Very important
 ☐ Important
 ☐ Neutral
 ☐ Not important
 ☐ Don't know

15. How important do you think each of the following is to maintaining and improving the quality of life in Wicken Parish?

Please tick only one box per row

	Very Important	Important	Neutral	Not Important	Don't know
The small size of the village and its relationship with the landscape	<input type="checkbox"/>	<input type="checkbox"/>	<input type="checkbox"/>	<input type="checkbox"/>	<input type="checkbox"/>
The presence of the village greens at the heart of the village	<input type="checkbox"/>	<input type="checkbox"/>	<input type="checkbox"/>	<input type="checkbox"/>	<input type="checkbox"/>
The presence of an internationally important nature site, Wicken Fen	<input type="checkbox"/>	<input type="checkbox"/>	<input type="checkbox"/>	<input type="checkbox"/>	<input type="checkbox"/>
The presence of Kingfisher Bridge Nature Reserve	<input type="checkbox"/>	<input type="checkbox"/>	<input type="checkbox"/>	<input type="checkbox"/>	<input type="checkbox"/>
The rural and historic character of the village and the protections provided by the Conservation Area	<input type="checkbox"/>	<input type="checkbox"/>	<input type="checkbox"/>	<input type="checkbox"/>	<input type="checkbox"/>
The ready access to open countryside	<input type="checkbox"/>	<input type="checkbox"/>	<input type="checkbox"/>	<input type="checkbox"/>	<input type="checkbox"/>

16. Please tell us if you agree or disagree with these statements.

Please tick only one box per row

Agree

Disagree

Not sure

All new development must demonstrate that it maintains or enhances wildlife habitats

Our lodes are an important asset to the village

Local greens, verges and recreation grounds are an important asset to the village

Our hedgerows and mature trees need to be protected

The relatively dark night sky in our neighbourhood is an asset

17. Would you support any of the following initiatives in the parish?

Please tick one box per row:

Important

Not important

No opinion

Leave verges to grow wild.

Improve planted areas within the Parish

Partnership with National Trust to extend their work out into the villages.

Partnership with Kingfisher Bridge Reserve to extend their work out into the villages

Identify, improve and enhance local ponds and create new ponds

Assist wildlife within the Parish eg provide hedgehog routes through fences, install bird and bat boxes

Community gardens

Community allotments

Community orchards

Additional tree planting

18. Do you have any other comments on our natural environment or suggestions for possible environmental initiatives?

--

Communication and Transport

We want to collect up-to-date robust information on communications and transport to help guide potential support for initiatives.

19. How do you view the broadband service in Wicken Parish?

Please tick only one box

☐ Very good ☐ Satisfactory ☐ Not very good ☐ Don't know ☐ Don't have broadband

Who is your supplier?

20. How do you view the mobile phone service in Wicken Parish?

Please tick only one box

☐ Very good ☐ Satisfactory ☐ Not very good ☐ Don't know ☐ Don't have a mobile

Who is your supplier?

21. How often do you generally use the bus services through Wicken Parish (Tiger on Demand and Thursday services)?

Please tick only one box

☐ Daily ☐ Weekly ☐ Monthly ☐ Occasionally ☐ Never

22. What changes to the bus service would increase your usage, if any?

Please write your views

23. How often do you use a taxi service to or from the Parish?

Please tick only one box

☐ Daily ☐ Weekly ☐ Monthly ☐ Occasionally ☐ Never

Traffic

The Parish Council has taken all cost-effective measures to slow down traffic. Although speed cameras would effectively address the speeding problem in the village, the Parish Council does not have the authority to install them.

Speeding has been included in the survey, as new affordable solutions may become available in the future.

Whilst many highway improvements do not require planning permission, we want to collect up to date, robust information to help guide potential initiatives in the future.

24. Do you think we need to do more to slow down through traffic?

☐ Yes ☐ No

25. Do you think we need to do more to discourage through traffic?

☐ Yes ☐ No

26. Do you think we need to do more to stop HGVs transiting the village?

☐ Yes ☐ No

Services and Amenities

27. How often do you use the following facilities?

Please tick only one box per row

	Daily	Weekly	Monthly	Less often	Never
The Maids Head pub	<input type="checkbox"/>	<input type="checkbox"/>	<input type="checkbox"/>	<input type="checkbox"/>	<input type="checkbox"/>
The Five Miles from Anywhere pub	<input type="checkbox"/>	<input type="checkbox"/>	<input type="checkbox"/>	<input type="checkbox"/>	<input type="checkbox"/>
St Laurence's Church	<input type="checkbox"/>	<input type="checkbox"/>	<input type="checkbox"/>	<input type="checkbox"/>	<input type="checkbox"/>
The Methodist Church	<input type="checkbox"/>	<input type="checkbox"/>	<input type="checkbox"/>	<input type="checkbox"/>	<input type="checkbox"/>
The Village Hall	<input type="checkbox"/>	<input type="checkbox"/>	<input type="checkbox"/>	<input type="checkbox"/>	<input type="checkbox"/>
Wicken Fen including café and shop	<input type="checkbox"/>	<input type="checkbox"/>	<input type="checkbox"/>	<input type="checkbox"/>	<input type="checkbox"/>
Kingfisher Nature Reserve and shop	<input type="checkbox"/>	<input type="checkbox"/>	<input type="checkbox"/>	<input type="checkbox"/>	<input type="checkbox"/>
Spinney Abbey Farm	<input type="checkbox"/>	<input type="checkbox"/>	<input type="checkbox"/>	<input type="checkbox"/>	<input type="checkbox"/>
Wicken Windmill	<input type="checkbox"/>	<input type="checkbox"/>	<input type="checkbox"/>	<input type="checkbox"/>	<input type="checkbox"/>
The tennis court	<input type="checkbox"/>	<input type="checkbox"/>	<input type="checkbox"/>	<input type="checkbox"/>	<input type="checkbox"/>
The football pitch	<input type="checkbox"/>	<input type="checkbox"/>	<input type="checkbox"/>	<input type="checkbox"/>	<input type="checkbox"/>
The play equipment on the Rec	<input type="checkbox"/>	<input type="checkbox"/>	<input type="checkbox"/>	<input type="checkbox"/>	<input type="checkbox"/>
The allotments	<input type="checkbox"/>	<input type="checkbox"/>	<input type="checkbox"/>	<input type="checkbox"/>	<input type="checkbox"/>
Exercise machines on the Rec	<input type="checkbox"/>	<input type="checkbox"/>	<input type="checkbox"/>	<input type="checkbox"/>	<input type="checkbox"/>
Hard surface Multi-Use Games Area at the Rec (tennis court)	<input type="checkbox"/>	<input type="checkbox"/>	<input type="checkbox"/>	<input type="checkbox"/>	<input type="checkbox"/>
Fishing rights on the Lode	<input type="checkbox"/>	<input type="checkbox"/>	<input type="checkbox"/>	<input type="checkbox"/>	<input type="checkbox"/>

28. What other services and amenities would you like to see in the village?

Please write your views here

29. If applicable, do you agree that any of the following would help your experience of working, running a business, or studying in Wicken Parish?

Please tick one box per row:

	Strongly Agree	Agree	Neutral	Disagree	Strongly Disagree
Flexible/shared office or workshop facilities	<input type="checkbox"/>	<input type="checkbox"/>	<input type="checkbox"/>	<input type="checkbox"/>	<input type="checkbox"/>
Meeting rooms	<input type="checkbox"/>	<input type="checkbox"/>	<input type="checkbox"/>	<input type="checkbox"/>	<input type="checkbox"/>
Private office or workshop facilities	<input type="checkbox"/>	<input type="checkbox"/>	<input type="checkbox"/>	<input type="checkbox"/>	<input type="checkbox"/>
Rentable office space	<input type="checkbox"/>	<input type="checkbox"/>	<input type="checkbox"/>	<input type="checkbox"/>	<input type="checkbox"/>
More reliable broadband	<input type="checkbox"/>	<input type="checkbox"/>	<input type="checkbox"/>	<input type="checkbox"/>	<input type="checkbox"/>
Greater advertising of local employment opportunities	<input type="checkbox"/>	<input type="checkbox"/>	<input type="checkbox"/>	<input type="checkbox"/>	<input type="checkbox"/>
Something else? Please tell us. <div style="border: 1px solid black; height: 60px; margin-top: 5px;"></div>					

About you and your household

These final questions will help us in the analysis of the results and in developing recommendations for the Neighbourhood Plan. We will not be using the results to identify individuals but to look at the views of specific groups within the village.

You can omit any questions you prefer not to answer.

PLEASE WOULD ONLY ONE PERSON PER HOUSEHOLD COMPLETE QUESTIONS 30-36

30. What are the ages of those that normally live in your household?

Please tick only one box per row as applicable to the number of people in your household:

	Under 16	16-29	30-44	45-59	60-74	75 and over
Person 1	<input type="checkbox"/>	<input type="checkbox"/>	<input type="checkbox"/>	<input type="checkbox"/>	<input type="checkbox"/>	<input type="checkbox"/>
Person 2	<input type="checkbox"/>	<input type="checkbox"/>	<input type="checkbox"/>	<input type="checkbox"/>	<input type="checkbox"/>	<input type="checkbox"/>
Person 3	<input type="checkbox"/>	<input type="checkbox"/>	<input type="checkbox"/>	<input type="checkbox"/>	<input type="checkbox"/>	<input type="checkbox"/>
Person 4	<input type="checkbox"/>	<input type="checkbox"/>	<input type="checkbox"/>	<input type="checkbox"/>	<input type="checkbox"/>	<input type="checkbox"/>
Person 5	<input type="checkbox"/>	<input type="checkbox"/>	<input type="checkbox"/>	<input type="checkbox"/>	<input type="checkbox"/>	<input type="checkbox"/>
Person 6	<input type="checkbox"/>	<input type="checkbox"/>	<input type="checkbox"/>	<input type="checkbox"/>	<input type="checkbox"/>	<input type="checkbox"/>
Person 7	<input type="checkbox"/>	<input type="checkbox"/>	<input type="checkbox"/>	<input type="checkbox"/>	<input type="checkbox"/>	<input type="checkbox"/>

31. How many years has your household lived in Wicken Parish?

Please tick one box:

☐ 0-5 years
 ☐ 6-10 years
 ☐ 11-15 years
 ☐ over 15 years

32. What is the employment status of the persons over 16 in your household?

Please tick the box for the number of people who fit each category (ie each row) and only provide one answer per row:

	1	2	3	4	5
Working full time paid employment	<input type="checkbox"/>	<input type="checkbox"/>	<input type="checkbox"/>	<input type="checkbox"/>	<input type="checkbox"/>
Working part time paid employment	<input type="checkbox"/>	<input type="checkbox"/>	<input type="checkbox"/>	<input type="checkbox"/>	<input type="checkbox"/>
Not working, looking for work	<input type="checkbox"/>	<input type="checkbox"/>	<input type="checkbox"/>	<input type="checkbox"/>	<input type="checkbox"/>
Not working, not looking for work	<input type="checkbox"/>	<input type="checkbox"/>	<input type="checkbox"/>	<input type="checkbox"/>	<input type="checkbox"/>
Not able to work	<input type="checkbox"/>	<input type="checkbox"/>	<input type="checkbox"/>	<input type="checkbox"/>	<input type="checkbox"/>
Student	<input type="checkbox"/>	<input type="checkbox"/>	<input type="checkbox"/>	<input type="checkbox"/>	<input type="checkbox"/>
Retired	<input type="checkbox"/>	<input type="checkbox"/>	<input type="checkbox"/>	<input type="checkbox"/>	<input type="checkbox"/>

Other – please state

33. Of those over 16 living at home and in work or full-time study, where do they usually work or study?

Please tick the appropriate box for the number of people who fit each category (ie each row) and only provide one answer per row:

	1	2	3	4	5
Work/study from home	<input type="checkbox"/>	<input type="checkbox"/>	<input type="checkbox"/>	<input type="checkbox"/>	<input type="checkbox"/>
Wicken parish	<input type="checkbox"/>	<input type="checkbox"/>	<input type="checkbox"/>	<input type="checkbox"/>	<input type="checkbox"/>
Burwell	<input type="checkbox"/>	<input type="checkbox"/>	<input type="checkbox"/>	<input type="checkbox"/>	<input type="checkbox"/>
Soham	<input type="checkbox"/>	<input type="checkbox"/>	<input type="checkbox"/>	<input type="checkbox"/>	<input type="checkbox"/>
Swaffham Prior	<input type="checkbox"/>	<input type="checkbox"/>	<input type="checkbox"/>	<input type="checkbox"/>	<input type="checkbox"/>
Swaffham Bulbeck	<input type="checkbox"/>	<input type="checkbox"/>	<input type="checkbox"/>	<input type="checkbox"/>	<input type="checkbox"/>
Ely	<input type="checkbox"/>	<input type="checkbox"/>	<input type="checkbox"/>	<input type="checkbox"/>	<input type="checkbox"/>
Newmarket	<input type="checkbox"/>	<input type="checkbox"/>	<input type="checkbox"/>	<input type="checkbox"/>	<input type="checkbox"/>
Fordham	<input type="checkbox"/>	<input type="checkbox"/>	<input type="checkbox"/>	<input type="checkbox"/>	<input type="checkbox"/>
Burwell	<input type="checkbox"/>	<input type="checkbox"/>	<input type="checkbox"/>	<input type="checkbox"/>	<input type="checkbox"/>
Cambridge	<input type="checkbox"/>	<input type="checkbox"/>	<input type="checkbox"/>	<input type="checkbox"/>	<input type="checkbox"/>
Elsewhere in Cambridgeshire	<input type="checkbox"/>	<input type="checkbox"/>	<input type="checkbox"/>	<input type="checkbox"/>	<input type="checkbox"/>
London	<input type="checkbox"/>	<input type="checkbox"/>	<input type="checkbox"/>	<input type="checkbox"/>	<input type="checkbox"/>
Elsewhere, please specify:					

34. How do you and those in work or full-time study normally travel to work or study?

Please tick the box for the number of people who fit each category (ie each row) and only provide one answer per row:

	1	2	3	4	5
Work/study from home	<input type="checkbox"/>	<input type="checkbox"/>	<input type="checkbox"/>	<input type="checkbox"/>	<input type="checkbox"/>
Car/van driver	<input type="checkbox"/>	<input type="checkbox"/>	<input type="checkbox"/>	<input type="checkbox"/>	<input type="checkbox"/>
Car/van passenger	<input type="checkbox"/>	<input type="checkbox"/>	<input type="checkbox"/>	<input type="checkbox"/>	<input type="checkbox"/>
Car share	<input type="checkbox"/>	<input type="checkbox"/>	<input type="checkbox"/>	<input type="checkbox"/>	<input type="checkbox"/>
Bus, including work or school bus	<input type="checkbox"/>	<input type="checkbox"/>	<input type="checkbox"/>	<input type="checkbox"/>	<input type="checkbox"/>
Motorcycle	<input type="checkbox"/>	<input type="checkbox"/>	<input type="checkbox"/>	<input type="checkbox"/>	<input type="checkbox"/>
Bicycle	<input type="checkbox"/>	<input type="checkbox"/>	<input type="checkbox"/>	<input type="checkbox"/>	<input type="checkbox"/>
Taxi	<input type="checkbox"/>	<input type="checkbox"/>	<input type="checkbox"/>	<input type="checkbox"/>	<input type="checkbox"/>
Train	<input type="checkbox"/>	<input type="checkbox"/>	<input type="checkbox"/>	<input type="checkbox"/>	<input type="checkbox"/>
Walk	<input type="checkbox"/>	<input type="checkbox"/>	<input type="checkbox"/>	<input type="checkbox"/>	<input type="checkbox"/>
Other, please specify					

35. Do you or anyone in your household intend to move from Wicken Parish in the next 5 years?

Please tick only one option:

☐ Yes ☐ No

36. If you answered YES to question 35, what are the main reasons for wanting or needing to move?

Tick all that apply:

To move closer to family or friends	<input type="checkbox"/>	Retirement	<input type="checkbox"/>
Wanting an easier home to maintain	<input type="checkbox"/>	Traffic impacts on my quality of life	<input type="checkbox"/>
Wanting to buy a home	<input type="checkbox"/>	To move to an accessible home	<input type="checkbox"/>
Wanting to buy a new build home	<input type="checkbox"/>	To move to a larger home	<input type="checkbox"/>
Wanting to rent a home	<input type="checkbox"/>	To move to a smaller home	<input type="checkbox"/>
To set up own home	<input type="checkbox"/>	To provide care for family/friends	<input type="checkbox"/>
To be closer to work or a new job	<input type="checkbox"/>	Wanting a bigger garden	<input type="checkbox"/>
To make it easier to receive care/support	<input type="checkbox"/>	Wanting a smaller garden	<input type="checkbox"/>
To move to a different school catchment area	<input type="checkbox"/>	To move to a better neighbourhood	<input type="checkbox"/>
To move to an area with more accessible services i.e. GP, shops, public transport	<input type="checkbox"/>		<input type="checkbox"/>

Other reasons, please specify:

Have we missed anything?

37. If you think there are any important points missed by this survey, please note them in the box below.

Thanks for completing the survey.