

April & May 2020

Around and About



© National Trust Images/Richard Nicoll Photography. Registered Charity Number 205816.



Wicken Fen Nature Reserve

Get close to nature at Wicken Fen

Reserve open daily, dawn to dusk
Visitor Centre, Shop, Café and
Cycle hire open daily, 10am - 5pm

01353720274
nationaltrust.org.uk/wickenfen

National Trust



WICKEN'S COMMUNITY MAGAZINE

Around and About
is printed by

BURWELL
PRINT
CENTRE

A social enterprise training & supporting adults with
learning disabilities, providing quality design & print
www.burwellprint.co.uk | 01638 613 102

Website: wicken-village.org.uk

£1 where purchased



PRESTIGE *Fire Safety Ltd*

☎ 01353 886006
✉ info@prestigefiresafety.com
🌐 www.prestigefiresafety.com
🏠 2 Drury Lane, Wicken, CB7 5XY

Fire Extinguisher Supply & Servicing
Fire Alarm Installation & Maintenance
Staff Fire Warden & Fire Awareness Training
Fire Risk Assessments & Fire Safety Equipment



HONDA
The Power of Dreams



Honda at Soham



Crown Garage

1-5 High Street, Soham, Cambridgeshire CB7 5HB
Call 01353 720779 or visit www.crowngarage.co.uk

Radis is a family-owned business, our services range from short, 15-minute visits through to full 24-hour care, including Live In, Supported Housing and Complex Care. This allows a bespoke care plan to be created so our clients can access our full continuum of care.

We provide these services to a range of Service User groups including Younger Adults, Older people, people with Learning Disabilities, people with Physical Disabilities and people with Mental Health conditions.

Included in our role we can assist with:

- ◇ Companionship
- ◇ Personal care
- ◇ Clinical care needs such as ventilation, PEG, continence care,
- ◇ Autonomic Dysreflexia management, tracheostomy care
- ◇ Medication
- ◇ House work & shopping
- ◇ And much more

Our focus on consistency in staffing and approaches ensures that individuals' dignity, choice and control are maintained at all times, in all circumstances.

If you would like to discuss your care options please call us on:

03301008199 or email us at enquiries@radis.co.uk



Bus Times - Bus 117 - Thursday Service Only			
Upware	1040	Ely Market Street	1355
Wicken Church	1047	Stuntney	1401
Soham High Street	1058	Barway	1410
Barway	1110	Soham High Street	1422
Stuntney	1119	Wicken Church	1433
Ely Market Street	1125	Upware	1440

The Staploe Medical Centre:-Open: Weekdays 8.30am – 6.00pm;
Saturdays 8.30am – 10.30am

Tel: Appointments 01353 624121
Prescriptions and Dispensary 01353 624122
Emergencies Enquiries and Home Visits 01353 624123

Ely, Soham and District Dial-a-Ride 01353 661161

WE'LL BE THERE
FROM 2YD TO 20YD SKIPS DELIVERED TO YOUR DOOR

CALL US
ALLEN'S SKIP HIRE LTD

TOPSOIL, AGGREGATES AND hardcore (Delivered Or Collected)



- Skips From 2 Yards To 20 Yards
- Same Day Service • 8 Wheel Tippers
- Sand, Gravel & Aggregates

GRAB LORRY FOR HIRE





info@allenskiphire.co.uk

ELY 01353 881047

www.allenskiphire.co.uk

WILLOW ROW, TEN MILE BANK, LITTLEPORT, ELY, CAMBS

Around & About Wicken

Published six times per year in April, June, August, October, December and February. Circulation 375. Delivered free to every household in the parish. **£1 when purchased**

Editor

Merrilyn Fry
4 Stretham Road Wicken CB7 5XH
01353 720080
mer.724@btinternet.com

Treasurer and Advertising Manager

Nigel Davies
28 Chapel Lane Wicken
Taximan19CLH@aol.com
01353 721037

Distribution

Rachel Earl
42 Chapel Lane Wicken
01353 723619

Advertising Rates

Small adverts (B&W) are £5.00 per issue.

Display advertising per annum (6 issues):

1/8 page	£15.00	1/4 page	£30.00
1/2 page	£55.00	Whole page	£100.00

We make every effort to ensure contents are correct but regret we cannot accept liability for views expressed or for errors or omissions.

Liability to our advertisers for errors and omissions attributable to us is limited to credit or reimbursement of the price paid by them for advertising in the issue in which their erroneous or omitted advertising occurred.

Please note that views expressed in published articles are not necessarily those held by the A&A team.'

Cover Pictures

Cover - Chris Buxton (our 'postie')
Inside Front cover - Kate Amann

Contents

A&A Information	page 3
Editors Note	page 5
Report from the Parish Clerk	page 6
Parish Councillors	page 7
Wicken Covid 19 Mutual Aid Support Network	page 8
Marquees for Hire	page 9
URA	page 9
TERRACYCLE	page 10
Village Hall	page 11
Wicken Fen	page 12
Swallowtails	page 13
Wicken Beer Festival	page 13
Wicken Fete & Dog Show	page 13
Plastic Bottle Tops	page 13
Celebratory Bike Ride	page 14
Coffee Morning	page 15
The Beloes Bench	page 16
Wicken Horticultural Society	page 18
Where Do Things Go?	page 19
Life On The Fen	page 20
Celebrate VE Day	page 21
Village Speeding	page 21
Make Your Garden Hedgehog Friendly	page 22
Advertisers	page 23 - 39
Buses	page 40
Staploe Medical Centre	page 40

Advertiser	Phone	E-mail/Web
K-domestic Electrical	01638 610438 07541 008613	enquiries@k-elecsolutions.com www.k-elecsolutions.com
Keeleys Sales, Letting & Property Management	01353 663036	enquiries@keelys.net / sales@keelys.net
Lode Sports Injury Practice	07872 499209	www.karenabouzar.co.uk karenabouzar@hotmail.co.uk
Marks Yard Clearance	07549 341842	
Maths & Science Tutor	07826 620889	
Painter & Decorator - Kevin Jennings	01353 698285	
Pilates	01353 749611	liz.dolman@lovepilates.co.uk
Paul Braybrooke	01353 777788 07946 735691	
P.R.E. Heating Services	07500 800441 01638 721343	preheatingservices@gmail.com
Prestige Fire Safety Ltd	01353 886006	info@prestigefiresafety.com www.prestigefiresafety.com
Prime Book Keeping Services	01353 664453	www.primebs.co.uk
Radis Community Care	0330 1008199	enquiries@radis.co.uk
Rothwell's Carpet Cleaning	01223 832928	Www.rothwells.biz
Rox Vox Choir		www.rockvoxchoir.co.uk
Secretarial/Admin Assistance	01353 725126	jmjwatkins@talktalk.net
Specialist Dyslexic Teacher	01353 667035	
Spinney Abbey Meat	07803 132561	jonny@spinneyabbey.co.uk
Steves Coal	01353 771491	www.stevescoal.co.uk
TH Tree Surgery	07442 53472 01638 724000	info@thtreesurgery.co.uk www.thtreesurgery.co.uk
The Five Miles, No Hurry	01353 721654	www.fivemilesinn.com
The Foot Clinic (Chiropody)	07909 943171	marisa.jolley@live.co.uk
The Hair Shop	01353 722734	
The Maids Head	01353 720727	info@maidsheadwicken.com
The Red Lion	01353 771633	info@the.redlionsoham.co.uk
Toppers Hair Design	01353 663773	
Wicken Fen, National Trust	01353 720274	www.wicken.org.uk
Wicken Four Wheel Drive	01353 722434	www.wicken4x4.co.uk
Wicken Heating & Plumbing Service	01353 722613	
Yoga at Butts Farm, Sophie Leek	01353 721681	sophie.leek@btinternet.com

Advertiser	Phone	E-mail/Web
Air Broadband	01223 653400	sales@airbroadband.co.uk
AJM Property Enhancement	0752 681391	
Alex JP Scott Photography	01353 969917	
Allen's Skip Hire	01353 881047	www.allenskiphire.co.uk
Architectural Design Service	0799 275841	daniel@dcn-design.com
Art Psychotherapist	07515 512321	
Auricular Acupuncture	07716 411489	
Bishop Fireplace & Chimney Services Ltd	01366 377283 01353 860391	Fireplaces/Liners All other enquiries
Business Web Promotions	01353 648 057	neil@elymt.co.uk
Carpentry & Building Services	01353 741025 07719 615248	
C E Fuller & Co Funeral Director	01353 720439	
Co-op Funeral Service	01353 922000	
Crown Garage	01353 720779	www.crowngarage.co.uk
C W Kirk Lawnmowers	01638 744349	www.cwkirklawnmowers.co.uk
Dapper Dogs of Wicken	01353 624610	
Domestic Appliance Repairs	01353 699600 07867 553836	
D T A Plumbing & Heating	07955 321274	
East Anglia Domestic Appliance Repairs	07895 016658	andydaviesdomestic@hotmail.com www.eastangliadomestic.co.uk
Elizabeth Houghton	01353 723157	ehh@houghtonhealth.co.uk
Ely Design Group	01353 649649	mail@elydesignngroup.co.uk www.elydesignngroup.co.uk
Fenland Spirit Services (Gardening)	07753 836499	
Footcare in your own home	07773 615535	
Four Seasons Tree Services	01353 721665 07771 707921	
Fully Fitted Bathrooms and Boilers	01353 720185	www.fullyfittedbathrooms.co.uk.
Hair Shop	01353 722734	
Ian Bailey, Decorator	07798 711472	
Jager Pest Control	01353 361688 07526 797711	
J. Woodroffe Building Maintenance	01353 721857	

Editor's Note

As you will appreciate there will not be any village activities for the foreseeable future, therefore there is very little content for this issue of the magazine and unless the situation changes significantly I cannot say what will happen to the magazine in the future.

This short edition will only appear online as the printers , along with all other non-essential businesses, are closed.

In the hope that business shut down will not be in place for the entirety of April & May I have left the advertiser details in so, should you need anyone when life takes on some semblance of normality the details will be available to you.

I wish you all the best Easter you can have in the current circumstances. If you believe in prayer pray for our NHS and frontline key workers, our nation; our world, wisdom for our leaders and for the global response in dealing with this virus and for future co-operation.

I hope that we all stay well.

*Take care,
Merrilyn*

Report from the Parish Clerk

Newsletter

As there is no paper copy of Around & About this month, the Parish Council will be delivering a one-page Newsletter informing those that are not electronically connected of what is available to them during this period of Coronavirus restrictions. For those that are electronically connected the following is available and the best way to track what is happening in real time:

Wicken Website

You may have noticed that Wicken has a new website, <http://wicken-village.org.uk>. Thank you to Matt Cannon for all his hard work with this. It has been an ongoing project which was completed at super quick speed in the end. If you would like anything added to the website please email it to me and I will arrange for it to be added (if appropriate!)

Wicken Parish Council Facebook Page

The Parish Council now has its own Facebook page. This will include village news and events as well as having the meeting agenda and minutes.

Cemetery Footpaths and Mortuary Chapel

We were delighted to hear recently that Wicken has been awarded a grant from the Amy Community Fund to help us repair the footpaths and Mortuary Chapel in the cemetery! This is fantastic news and we're really grateful to everyone who wrote letters of support: it's all been worth it! The Parish Council will also contribute monies from the CIL funding we receive from new houses built in the parish.

Of course, with the current restrictions, we're not sure when the work will be able to begin but we'll be in touch with the contractors and will get ahead with it as quickly as possible.

Village Clean Up

The annual Village Clean Up was held on Sunday 15th March 2020. Although the weather was terrible, we had 16 parishioners take part and we managed to collect 12 bags of rubbish. Thank you to everyone who helped.

Foot care in your own home.

Do you need help with - corns, calluses, and verrucas, in-growing toe nails, dry and thickened heels, fungus infections and other conditions.

Please call for further information or to make an appointment.

Mary Gris-07773615535
SRN, OND and Registered Foot Health Care Professional.

*The
Ely
Foot
Care
Nurse*





D.T.A plumbing & heating
Gas Safe & Oftec.

Mobile: 07955 321274

**Boiler breakdowns; Heating system;
Bathroom**

Bishop Fireplace & Chimney Services Ltd

FIREPLACES, SURROUNDS, MULTIFUEL STOVES
AND LINERS SUPPLIED & FITTED
BRUSH & VACUUM CHIMNEY SWEEP
POTS, COWLS & BIRD GUARDS FITTED
ESTABLISHED SINCE 1963



FIREPLACES / LINERS (01366) 377283
ALL OTHER ENQUIRIES (01353) 860391

CHIMNEYS
39 WISBECH ROAD
LITTLEPORT
CAMBS CB6 1JH

ROCK VOX CHOIR

Your local friendly rock choir in the heart of the fens.



Love singing? Want
me meet new,
like minded people?
Come and join us for
a free taster session!

**ROCK
POP
SOUL
SOCIAL
FUN**

Rehearsals Sunday Evenings 7pm - 9pm
Prickwillow Village Hall

No previous choir experience necessary,
no nerve-wracking audition process, no
requirement to read notes. All you need
is a passion for music.

For more information and to book a taster session please visit our website.

www.rockvoxchoir.co.uk



Here for you
every hour
of every day

14 Prickwillow Road, Ely
01353 634457

www.eastofengland.co.uk/funerals



BRYAN LELY

DOMESTIC APPLIANCE REPAIRS

WASHING MACHINES DISHWASHERS
TUMBLE DRYERS COOKERS FRIDGES
VACUUM CLEANERS

80 Cannon Street
Little Downham

Nr Ely
Cambs CB6 2SS

Telephone 01353 699 600
Mobile 07867 553 836



Are you in Self-Employed or in Business?
Need help with your financial paperwork?

Put your finances in the hands of
Prime Bookkeeping Services
Self assessment tax returns, VAT, Bookkeeping

Call David on 01353 664453

www.primebs.co.uk

Parish Council Meetings

We are currently waiting for guidance from the National Association of Local Councils as to how we hold meetings whilst complying with social distancing. We are hopeful that virtual meetings can be held but we will announce this on the website and Facebook page.

Allotments

We currently have 2 allotments available at the Afterway Allotments along Lower Road. Rent is £6 per annum, this price reflects the fact that there is no water available at these allotments. Please contact me if you are interested in renting one.

Rachel Earl

Parish Clerk

wickenparishcouncil@hotmail.com

Parish Councillors

Cécile Bye	24 High Street	624378
Jim Day	Red Barn Farm	720281
Marc Hawes	Sheep Walk Cottage, Padney Road	624895
Liz Houghton (Chair)	17 Chapel Lane	723157
Peter Rash	6 Butts Lane	07703 555711
Jilly Rogers	4 Butts Lane	721611
Mick Smith	Peacock Farm, Lower Road	
Liz Tory	Maddog Cottage, Upware	722203
Sue Wilson	28 Chapel Lane	721037
Clerk: Rachel Earl	42 Chapel Lane	723619



Wicken COVID-19 - Mutual Aid Support Network -

Hello Neighbour!

If you're self-isolating we can help. We are the Wicken COVID-19 Mutual Aid Support Network, we are all locals living in Wicken.

Looking For Help?

- ☎ Call/Text: 07961737020
- ✉ Email: WickenCoronaVirusHelp@Outlook.com
- 📘 Join our Facebook Group: "Wicken, Ely COVID-19 Mutual Aid Support Network"

We Can Help With...



Picking up shopping



Posting mail



A friendly phone call



Urgent supplies



Dog walking

Please Note: Items will be left on doorsteps.

COVID-19, aka Coronavirus, is highly contagious. Please avoid physical contact and keep 2m distance - especially if you are in a high-risk group. Let's ensure we're sharing nothing but kindness during these difficult times.



Wicken has a shop!

Spinney Abbey has been selling meat from the farm for over 10 years. We started selling our meat from a garage but as sales increased we expanded and in 2012 the new cutting room/farm shop was completed. We sell home reared, grass-fed Longhorn Beef, Gloucester Old Spots Pork, Spinney lamb and wild venison and with low overheads, we keep our prices down. All orders large or small very welcome.



We have a 5* Food Hygiene rating. We hold an alcohol Premises licence and produce and sell our Award Winning cider from the farm shop. Prices for cider start at £13 for 3 litre Bag-in-Box.



33-35 Stretham Road, Wicken.

Jonny: 07803 132 561

jonny@spinneyabbey.co.uk

Opening hours: Saturday: 9am – Noon although please phone anytime as we are often there.

www.spinneyabbey.co.uk

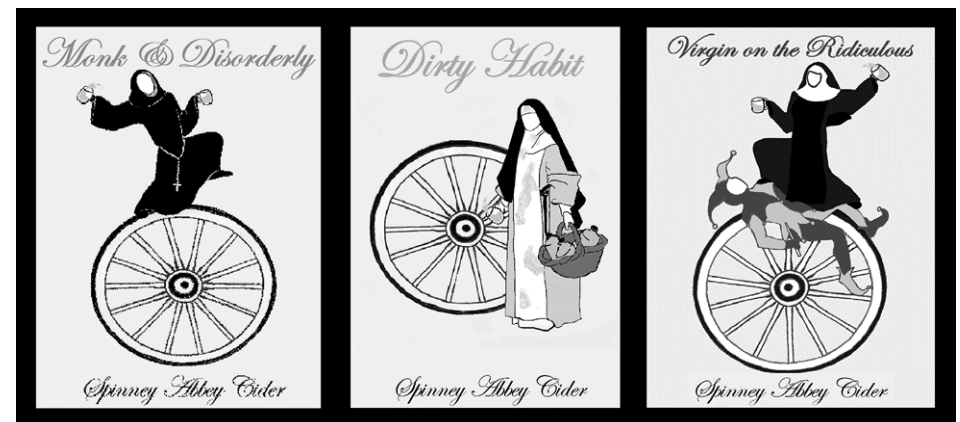



Sales, servicing, repairs and sharpening
of all types of garden machinery.

Collection and delivery available.

Friendly, local and professional service.



C.W. KIRK LAWMOWERS

01638 744 349

CWKIRKLAWMOWERS.CO.UK

44 NEWMARKET ROAD BURWELL CAMBRIDGESHIRE CB25 0AE

FOUR SEASONS TREE SERVICES

Qualified & Professional Tree and Client Care

PRUNING • LOPPING • FELLING
PLANTING • REDUCING & RESHAPING
CROWN RAISING • HEDGE TRIMMING
THINNING • POLLARDING • STUMP REMOVALS
OVERGROWN GARDENS PUT BACK INTO SHAPE
FRUIT TREES TREATED • LOG & WOODCHIP SALES

FREE ESTIMATES & ADVICE WITH NO OBLIGATION
For quality jobs at a competitive price call:

Home: 01353 721665 - Mob: 07771 707921

All work carried out to BS 3998 Standard

A genuine family managed business est. for over 30 years - Fully Insured



This company offers a 7 day cooling off period

DC Nicholls

architectural design services

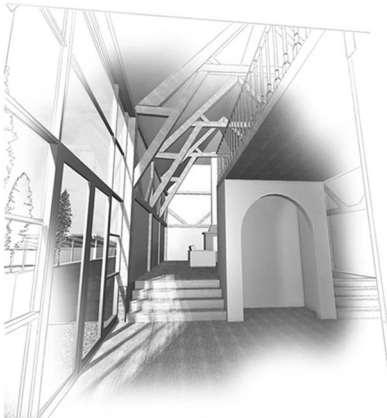

We offer design, planning, building regulations
and working drawings for:

- Extensions
- Renovations & alterations
- New developments

Full range of services from your project's inception
through to its completion, including:

- Topographical survey
- Feasibility study and sketch schemes
- 3D computer animated models and montages
- Detailed design and building regulation approval
- Specification and tender package preparation
- Site inspections

Call us to discuss your aspirations for your property.

www.dcn-design.com

Email: daniel@dcn-design.com Tel: 07949 275841

5 Cross Green. Wicken. Ely

MARQUEES FOR HIRE

The Parish Council has four marquees
available for hire by residents and businesses
of the Parish of Wicken

- The Marquees measure 2 x 30' x 30'; 1 x 30' x 20' and 1 x 20' x 15'
- Competitive rates of hire
- Technical assistance available to support you as you erect them
- See them at the village fete this year
- Why not book them for your own party?
- All proceeds raised will be used to support projects in the village

Phone: Rachel Earl (Clerk to the Parish Council)
for further details on 723619.

Upware Residents Association

Notice to the Upware Residents, due to Covid 19 the residents association
meeting in April is cancelled.

If any resident requires help over this isolation period please let The URA
Secretary know and she will try and get you assistance.

Hopefully this situation will be resolved and we will be able to hold the BBQ
on 19th July.

Please keep safe
Gwynneth Griffiths URA Secretary
gwynneth@fpandp.com
07825999179
Hillside House

Terracycle

Wicken has 3 collecting bins for the Terracycle recycling scheme.

Plastic packaging that cannot normally be recycled will be processed by Terracycle into pellets, which can be used to manufacture new items.

The bins are located at the Methodist Chapel, behind the bike racks.

Currently, we are able to collect the following items:

- ♦ Any brand of crisp packet, including the multipack bags
- ♦ Any brand of sliced bread bag
- ♦ Any brand of sweet biscuit plastic wrapper, including multipack packaging
- ♦ Any brand of confectionery bag or wrapper (see picture for guidance)
- ♦ Pringles tubes

Please do not add anything to the bins which is not on the list, as these plastics cannot be taken by the current scheme. Many thanks for your support and let's keep slimming Wicken's bins!



Plastic chocolate and sweets pouches and bags



Chocolate and sweets multipack outer plastic packaging



Individual chocolate bar wrappers



Plastic chocolate block wrappers



Packaging images are for illustrative purposes only

J. WOODROFFE

Building maintenance & property repairs, windows, doors, roofing and all types of carpentry & joinery etc.

All work carried out by qualified craftsmen

Tel: Ely 721857

EM'S CURTAIN DESIGNS

By Emma

Affordable luxury made to measure Curtains, Blinds and Cushions

07746849995

emscurtaindesigns@hotmail.com

emscurtaindesigns.com

C. E. FULLER & CO. FUNERAL DIRECTOR

23, Hall Street, Soham.

**AN OLD ESTABLISHED
FAMILY FIRM**

Private Chapel of Rest
Floral tributes and memorials supplied

Tel: Ely 720439

ELIZABETH HOUGHTON



Food Intolerance Testing
Nutritional Therapy
Human Iridology
Equine Iridology

t. 01353 723157
e: ehh@houghtonhealth.co.uk

Distributor of Forever Living Aloe Vera products and
Cytoplan Food State supplements

P.R.E. HEATING SERVICES

Registered Heating and
Plumbing Engineers

Oil and Gas Boiler Servicing,
repairs and installation
Fully guaranteed
Free quotations



Contact Phil Evans on:
07500 800441 or 01638 721343
preheatingservices@gmail.com



Servicing & repairs to all makes & models



Motorhome servicing & repairs

MOT's class 4 & 7

Air conditioning & LPG conversions

Vehicle recovery

Courtesy cars available

4 Wheel Drive Specialists

(01353) 722434

Lower Road, Wicken, Ely, Cambs CB7 5YB

**Website
Optimisation,
Promotion &
Marketing,
Upgrades
& Maintenance**

**Neil Ford
Ely Website SEO
Ely, Cambridge**

www.ely-website-seo.co.uk

Alex JP Scott Photography

**FAMILY PORTRAITS, TUTORIALS &
EVENTS**

Now taking bookings for the holiday
season and beyond

01353 969917

alexjpsscott@gmail.com

The Hair Shop



Maid's Head Yard
12a High Street
Wicken, Ely
Cambs CB7 5XR

01353 722734

Sue Griggs



WICKEN VILLAGE HALL

www.wickenvillagehall.org.uk

The Present Position

Sadly, the Hall is now closed. All the usual activities have ceased, and we are taking the opportunity to deep clean the building. The Trustees will continue to look after the premises and the facility is immediately available should it be required by the Local Authority in connection with the present emergency.

The Future

Although we have lost all our income, we are fortunate that the Hall has sufficient funds to survive for many months, if not years. You can rest assured that the Hall will be there ready to go when the country comes through this awful time.

In the meantime the regular booking slots will be kept for the various organisations until they start running again. If you have a longer term booking it remains unless you wish to cancel it. Similarly, we are happy to take future bookings in the usual way. Booking forms can be downloaded from the website together with instructions and prices.

If you have any queries please ring one of the Trustees.

Best wishes from the Hall Trustees

Current Committee trustees are:

Jean Turner (Chair) T:727054	Stephen Joyce (Secretary) T: 624443
Jack White (Treasurer) T 723342	Sophie Leek T:721681
Caroline Blott T:721480	Jason Clark Sonia Jones T:727140
Pam Joyce T: 624443	Jilly Rogers T:721611 Sue Wilson T 721037

Wicken Fen

The National Trust has recently published its Noticing Nature report in partnership with the University of Derby, which shows that there is a powerful link between how people relate to nature and their happiness. Spring is a great time to get outside and connect with nature, whether it's listening to birdsong, watching clouds or seeing wildflowers. Here at Wicken Fen we'll be seeing returning migrants such as warblers and cuckoos over the next few weeks, the first konik foals will soon be born, and shoots of emerald green foliage will be emerging across the reserve.

When the restrictions have been lifted you can after your walk on the reserve, pop into the new café building to see the improvements. The Docky Hut Café is a great space to relax and enjoy a tasty treat, with a larger seating area and counter; lighter, brighter environment; and a fully equipped kitchen now offering a wider range of refreshments.

<https://www.nationaltrust.org.uk/wicken-fen-nature-reserve>

Julia Hammond

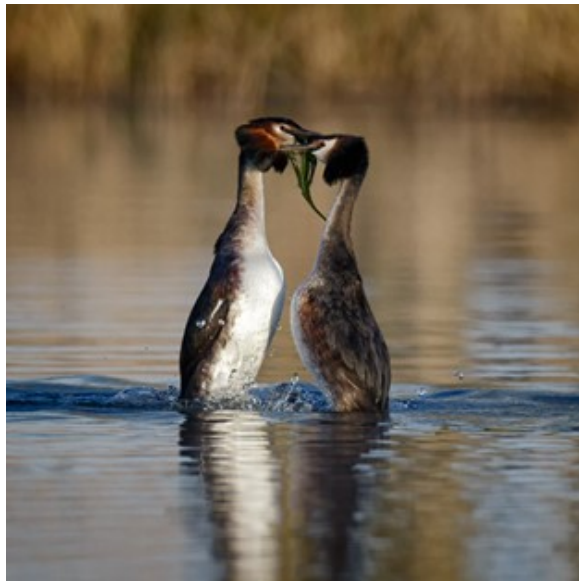

Great crested grebes by Richard Nicoll

East Anglia Domestic Appliance Repair



Washing Machines, Tumble Dryers,
Dishwashers, Ovens, Microwaves, Fridges &
Freezers.
Andy 07895 016658
Email: andydaviesdomestic@hotmail.com
www.eastangliadomestic.co.uk

TH Tree Surgery Limited

All Tree and Hedge Work Undertaken
Garden/Site Clearance
Seasoned Fire Wood
NPTC Qualified and Fully Insured

info@thtreesurgery.co.uk

www.thtreesurgery.co.uk

07442534712
01638724000

Registered Office No. 09024849



Alexander Innes

Maths Tuition - KS3, GCSE and
A Level.

Science Tuition - KS3, GCSE.

Give your child
the best chance
with tailor-made
one-to-one tuition.

07826 620889

alex.innesmathstutor@gmail.com



TOPPERS HAIR DESIGN

The Ultimate Luxury
Experience In
Hairdressing

01353 663773

18 Fore Hill - Ely
CB7 4AF

IAN BAILEY DECORATION SERVICES

No Jobs too big or too small.
Free estimates.

25 years experience.

Tel: 07798 711472

TRUSTED LOCKSMITHING SERVICES

THE LOCK GUYS

Call your local 24 hour locksmith

We can help with...

- 6 lock-outs
non-destructive entry specialist
- 6 lock repairs
we can quickly repair most locks
- 6 lock replacements & upgrades
we offer a free security check and advice to make your property more secure
- 6 burglary repairs
we can quickly secure your property, and then make lasting repairs
- 6 upvc repairs
we fix upvc windows and doors
- 6 garage doors
we fit, repair and upgrade locks
- 6 key cutting
on-site & while you wait
- 6 1 year warranty
peace of mind with our 12 month parts & labour guarantee

Call us now...
01353 930504
24 HOURS 07761 800 465

www.thelockguysltd.co.uk
info@thelockguysltd.co.uk



take a photo
of this ad on your
phone, you never
know when you
might need us!

Swallowtails

Swallowtails members enjoyed meeting together in February and early March, sharing two meals together one at the Hall, again cooked for us by Sue and one at The Five Miles From Anywhere where we were once again looked after by Lorraine, Dave and staff. Sadly the meal at the Five Miles was to be our last for some while as the planned outing to Nottingham for a boat trip had to be cancelled.

Our other meeting in February saw our members pondering over a general knowledge quiz with a picture round identifying castles and palaces.

We will meet again just as soon as the situation allows.

In the meantime we hope that everyone stays well.

Merrilyn

Wicken Beer Festival

You will not be surprised to learn but will no doubt be disappointed to hear that the 2020 Wicken Beer Festival planned for 16th May has been **CANCELLED**.

Liz Houghton

Wicken Fete & Dog Show 2020

Unfortunately due to the present serious Coronavirus situation it has been decided to **cancel** this year's fete.

Thank you to everyone for all the support you have given and look forward to 2021!

Jean, Sara & Norman

Plastic Bottle Tops

We are NO LONGER collecting Plastic Bottle Tops - thanks to everyone who has helped.

We are still collecting used postage stamps (cut them out of envelopes with half an inch border) and drink can ring pulls.

Sara Rains
Wicken Methodist Church

Celebratory Bike Ride

John Blackwell and Carl Shavitz embark today (Tuesday 31 March) in the last 40 miles of their celebratory bike ride to mark a mile for each of Carl's 80 years! Staying well apart throughout the ride, this is their one piece of exercise for today. And probably for a month!

They're raising funds for Macmillan Cancer Support and if any one wanted to support them, there's a Just giving page:

justgiving.com/fundraising/Carl-Shavitz

Jilly Rogers





Air Broadband (formerly RaSP)
Superfast Broadband for East Anglia



Superfast Broadband in Resch & Swaffham Prior
Get Connected NOW
East Anglia's fastest growing broadband company, based in Cambridge
01223 653 400
sales@airbroadband.co.uk

Fenland Spirit Services
Lawnmower Sales, Servicing & Repairs



Servicing from £45
Petrol lawnmowers and garden machinery fully serviced by a qualified engineer
Blade sharpening, collection available
Refurbished mowers sold
Ten Mile Bank, Littleport
Call us on 0775 383 6499
Or find us on Facebook/fenlandspiritservices 

Lode Sports Injury Practice



**Treatments for sports injuries
and painful muscular & skeletal conditions**

A fully qualified Sports Massage Practitioner based in Lode, treatments are not exclusively for sportsmen and sportswomen.

Fees, Massage Treatment is priced at:-
£25 for a 30 minutes, £45 for 1 hour
Special introductory offer for new clients.
Contact me for more information.
Web www.karenabouzar.co.uk
Email karenabouzar@hotmail.co.uk

Tel :-0787 2499209

Steves Coal

Cambridgeshire Premier Coal Merchant

- ♦ All types of solid fuel available including Premium House Coal and Smokeless Fuels.
- ♦ Nets of Hardwood, Softwood Logs and Kindling.
- ♦ Prices inclusive of delivery and a commitment to deliver your fuel as quickly as possible. Usually no more than two days.
- ♦ Check out our range of fuels on our Website www.stevescoal.co.uk

Steves Coal

Lt Downham

Ely

Phone 01353 771491

**Special offer
Smokeless fuels
from £300 per
tonne**

Compost2u
(Isle of Ely)

**Range of Gar-
den Products
with competi-
tive prices all
including free
delivery!**

01353 771491

**[www.compost2
uisleofely.co.uk](http://www.compost2u
isleofely.co.uk)**

New Customer
special offer:
£30 per tonne
discount
Quote Ref
New30

Coffee Morning

We had our first meeting in February and welcomed 2 new friends. Thanks to Caroline Blott for looking after the finances.

We had plans for the year ahead but sadly have **CANCELLED** our meetings until further notice.

We pray for your safety and well-being, attention to the advice given by the authorities.

Take care of yourself and Stay Home.

Happy Easter

For many of us who believe in the resurrection of Jesus on the third day it is Happy Easter.

In this difficult time of the virus affecting so many... let it be a time of reflection to the true meaning and importance of the cross at Easter time.

There's no Jewish way to be saved or Gentile way to be saved. The way of the Cross will give you the answers to your questions... take time to read the Bible.

Dalene Musora

Contact: Caroline Blott
Tel: 721480

Liz Jugg
968838

Dalene
0794 4219537

WICKEN HEATING & PLUMBING

Rory Woodroffe,
38 Chapel Lane, Wicken

**KITCHENS, BATHROOMS,
SHOWERS, TILING &
CENTRAL HEATING**

Installation and Repairs
All work carried out by qualified tradesmen and
guaranteed
PHONE: ELY 722613

Auricular Acupuncture. Shiatsu.
Electro Acupuncture.
Back Pain.

WEIGHT CONTROL.

Most conditions Treated.
Free consultation.

50% Discount for new patients.

Alison Basil E.A.S.S. (t)

Fen Farm 11 Padney Rd CB7 5YE

01353722649 07716411489

ajoybasil@yahoo.co.uk

The Beloes' Bench

On 14th March 2020 there were about 30 people in attendance to honour the memory of Rev Francis and Sheila Beloe who lived and served in Wicken between 1974 and 1999.

Amy Beloe made a speech, and I asked for a copy as I know several people who where unable to be there would appreciate the opportunity to read it:

"Mum and dad did everything together. Sitting on the sofa holding hands, Dad constantly telling Mum he loved her.

They both had their weaknesses but as Mum once said, they 'leaned on each other and this held them up'. Together they were a real force!

Moving from London in 1974 to a small rural setting must have been quite a shock, however they both embraced it and threw themselves into village life. One of the first years in Wicken, Dad joined in the potato harvest (which he loved), although I think he nearly got carried away on the conveyor belt! Mum helped start the 'Around and About' village magazine, and one of the background sounds of our lives was the duplicator which Ruth and I loved to turn the handle to print off hundreds of copies. Soon, it felt like Wicken was part of the family.

The vicarage was an open house and garden and there were summer nights Ruth and I strolled off to bed while other children continued to play in the garden, but it was past our bedtime. The kitchen was a hub of noise and entertainment. The kettle never cooled and there seemed rarely to not have someone sitting at the kitchen table chatting to mum and dad inbetween the phone being answered, the dogs barking and the doorbell ringing. Many meetings were held in our sitting room in the evenings, whether the Parish Council, Fete Committee or Fen Folly planning, they all sounded more like a party from upstairs as we listened to laughter and glasses chinking.

I believe Mum and Dad's time in Wicken was their happiest and know they would have loved to have stayed. After 25 years it was time for dad to retire. Not many people realised how his illness took its toll on us all, but with Mum's support, he worked until retirement age.

The move to Ely was with mixed emotions. Mum loved her new house and a manageable garden, Dad quickly made new friends with the neighbours. They threw themselves into life in Ely.

It soon became clear both Mum and Dad needed extra help. Incredibly, their house sold quickly and a flat came up in sheltered accommodation in Keswick the same week. Again, they threw themselves into life in the housing accommodation, the church and various other community-minded groups. Their tiny flat often had their neighbours in and here, too, the kettle was always boiling for another cup of tea.

Their adventure didn't end here, though, and Mum and Dad's next part of

k-domestic electrical solutions

your **local** electrical service of choice and recommendation

Complete installations & rewires

Small and large alterations

Lighting

Internal & External work

PAT testing

Periodic Inspection & Reports

Full Inspection, Testing, Verification & Certificate issue

LED

Under Floor Heating

Voltage Optimization

**24hr
CALLOUT**

Karl Howe
01638 610438
M: 07541 008613

Email: enquire@k-elecsolutions.com

Website: www.k-elecsolutions.com

Fully qualified Part P and 17th Edition

City & Guilds
Qualified

EAL

DOMESTIC
INSTALLER

TRUST
MARK

Pilates Classes

Pilates Flow Wed 8.30am

Pilates Fusion Thurs 8.30am

Fen Farm, Padney, Wicken

Pilates Flow Mixed Ability

- Thurs 6.10pm/7.15pm

Wicken Village Hall, Wicken, Cambs

Contact: Liz (07768) 155278 or
liz.dolman@lovepilates.co.uk for info

*www.lovepilates.co.uk for details on
other classes held in the local area*

Fully Fitted Bathrooms & Boilers

Plumbing & Heating Services
Oil & Gas

Power Flushing

System Upgrades

Boiler Installation

Hot & Cold Water Services

Insulation/Energy Efficiency

Free Advice/Surveys

www.fullyfittedbathrooms.co.uk

Jason Clarke

34 North Street, Wicken

t: 07909 683 842 e: info@fullyfittedbathrooms.co.uk

Paul Braybrooke

**OIL-FIRED BOILER ENGINEER
(OFTEC REGISTERED)**

BOILER SERVICING

BOILER BREAKDOWNS

TANK REPLACEMENT - PLASTIC OR METAL

ALL NEW BOILERS COMMISSIONED

**TELEPHONE ELY (01353) 777788
MOBILE 07946 735691**



**01223 832 928
www.Rothwells.biz**

Carpet Cleaning

Stone Floor, Upholstery & Rug Cleaning.

A few points that make us stand out from the others,

Rothwell's has been in business since 1993.

We're an honest local family firm.

**Our large truck mounted machines mean more cleaning
& drying power for the best results possible.**

Members of both the NCCA and TACCA.

We will move the furniture for a thorough clean.

100% satisfaction or it's FREE.

Call Oliver and Max Campbell for expert help today.

Rothwell's, Malting End, Kirtling, Newmarket, CB8 9HH

their journey was the most difficult, but I would say the most precious time we had as a family. Both fought their separate battles with dementia, both with a indomitable spirit, good humour and great faith. After a truly unforgettable five years Mum died, closely followed by Dad, who have up without his Sheila.

I truly believe they are reunited in Heaven, and are having a Wonderful Time.

I'm just going to read one of Dad's favourite passages from the Bible. This is about Jesus' perfect love. I believe through their cracks, this is what shone out...

If I could speak in any language in heaven or on earth but didn't love others, I would only be making meaningless noise like a loud gong or clanging cymbal. If I had the gift of prophecy, and if I knew all the mysteries of the future and knew everything about everything, but didn't love others, what good would I be? And if I had the gift of Faith so that I could speak to a mountain and make it move, without love I would be no good to anybody. If I gave everything I have to the poor and even sacrificed my body, I could boast about it; but if I didn't love others, I would be of no value whatsoever. Love is patient and kind. Love is not jealous or boastful or proud or rude. Love does to demand its own way. Love is not irritable, and keeps no record of when it has been wronged. It is never glad about injustice but rejoices whenever the truth wins out. Love never gives up, never loses faith, is always hopeful, and endures through every circumstance. Love will last forever.

1 Corinthians 12: 1 - 8

Sara Rains

If anyone has a photograph of the event please can you et me have a copy - we may be able to use it in the future many thanks.

Merrilyn (Editor)



Wicken Horticultural Society

Even though we are all currently living with a great deal of uncertainty, it can't go on forever so, in the spirit of optimism, we are still planning to hold a horticultural show this year, on 18th July 2020 - SAVE THE DATE!!

Getting some fresh air and having something positive to think about is particularly important right now, and working in the garden is a great way to get both. Perhaps you can encourage your stay-at-home children to get involved, giving them a focus as they see things they planted grow and flourish. We have lots of children's classes that involve them being creative (ok, maybe the 'necklace made of pasta' might have to go this year!), so there is a lot for them to do.

We will make a final decision on the show much nearer the date, but whatever happens, your garden will look great, you'll feel a lot better and have some great fresh fruit and veg and cake, so even if it doesn't go ahead you're still a winner!

Wicken Horticultural Show Committee

AJM PROPERTY ENHANCEMENTS

Does life get in the way of the garden you deserve?

You work all week and then have to work all weekend as well in your garden, when do you get the chance to actually enjoy relaxing in it?

We offer a competitive service and work hard to give you the garden you deserve. We offer advice on planting and know how to care for your plants. Let us enhance your garden with a regular or once off maintenance visit.

I run a insured business which cares and wants to add your garden to our portfolio.

Andrew McMahon 07592681391 / www.facebook.com/ajmpropertyenhancements

email ajmcarpentry@talktalk.net / website carpenterincambridge.co.uk



Sales, Letting & Property Management

When it's time to **SELL** or **LET** think Keeleys.net
Contact us today to book your free valuation



Jäger Pest Control

James Clark

Full Pest Control, Wildlife Management & Environmental Services

Pest Control

Rats Mice
Bees Wasps
Ants Fleas
Flies Moths

Wildlife Management

Deer Foxes
Moles Mink
Rabbits
Squirrels

Based in Wicken

Caterpillars

Birds (Pest Species)

Cockroaches

Fully Qualified BPCA Diploma 1 & 2

Bed Bugs

IOSH H & S Certificate

Quality Assurance Guaranteed

All Contract work undertaken

**MARK'S
YARD CLEARANCE
&
DELIVERIES**

**Fully licenced
Distance no problem
Any job done**



**CALL MARK ON
07549 341842**

The Village Foot Clinic
Wilburton

Clinic based & mobile Chiropody

Appointments for:

Diabetic foot care
Corns, Callous & Cracked Heels
Thickened Nail Reduction
Fungal Skin & Nail Infections

Full Assessment & Treatment
£28

Marisa Jolley MCFHP MAFHP

Tel: 07909 943171

marisa.jolley@live.co.uk

Where Do Things Go

*How things vanish
When you live on your own?
There is no one to take them
If you're all alone!*

*Inanimate objects
How can they fly?
Where do they go to
Where do they lie?*

*Why isn't my book
Just where I left it?
Where is that letter
I've only just read it?*

*There must be a reason
Why objects take walks
They really can't vanish
Or soar like the hawks.*

*There's no one to blame
When it is only just me
I think I'll give up
And just make some tea!*

By Masie Dance

*From the Waitrose Free Paper
Submitted by Martin Hopkins*

ARCHITECTURAL DRAWINGS

FOR

PLANNING & BUILDING REGULATION APPLICATIONS

EXTENSIONS, ALTERATIONS, LOFT CONVERSIONS ETC

CONTACT US now to arrange a **FREE** on-site meeting
at your convenience to discuss your project.

01353 649649
mail@elydesigngroup.co.uk

ELY DESIGN GROUP
'Architecture by Professionals'
www.elydesigngroup.co.uk

A fenman's work on Wicken Fen was guided by the season, and the weather.
A pattern of life that changed little over the centuries.

Life On The Fen

*We live by the lode, working out on the fen
It's a hard life but mostly we're happy
We're scything and catching, and cutting the peat
To put bread on the table for the family to eat*

We're all down the fen where there's turf to be dug
The men cut and barrow - it's tough
The girls and the youngsters, they quarter and stack
Then it's loaded on lighters and we haul it all back

The season is short, the pumps have been busy
Lifting the water away from the pits
The diggers work hard a-loading the saddle
Blighted by midges and having to paddle

*We live by the lode, working out on the fen
It's a hard life but mostly we're happy
We're scything and catching, and cutting the peat
To put bread on the table for the family to eat*

Life's tough for a fenman as many will tell
Our tasks being guided by the season
There's no point in a grumble – we just get stuck in
It's a life that we treasure for good reason

*We live by the lode, working out on the fen
It's a hard life but mostly we're happy
We're scything and catching, and cutting the peat
To put bread on the table for the family to eat*

Neil Ford
Ely, Cambridgeshire

Actively supporting The Princes Trust; EACH & NSPCC

© Neil Ford - www.neilford.co.uk - 2006 & 2019 All Rights Reserved
Links: [Cloud Nine Decor Ltd - Sheffield](#); [The Brook - Wallington, Surrey](#); [Wriggle-tots - Ely - Milton - Cambourne](#); [Brushworks - Ely](#); [4D Dance - Ely](#); [NSPCC](#); [East Anglia's Children's Hospices](#); [Prince's Trust](#)

KEVIN JENNINGS

**PAINTER
&
DECORATOR**
01353 698285



NIGEL INGRAM
CARPENTRY AND BUILDING SERVICES

Professional affordable service

Free quotations and advice

Telephone: 01353 741025

Mobile: 07719 615248

Wicklow House 29a Lode Way Haddenham,
CB6 3UL



**I am a Specialist
Dyslexic Teacher**
(Associate Member of
the British Dyslexia
Association)

I offer specialist tuition in the following
areas:-

- specialist dyslexic teaching
- help with reading, writing and spelling for both children and adults
- coaching for SATs
- all aspects of English
- help with primary and lower secondary Maths

For more information ring:-
Mary Smyth on 01353 667035

Dapper Dogs of Wicken

Professional Dog Grooming by
Sarah Cooper
NVQ qualified

- Styling to Breed Standard or Customers' Request
- Bath & Blow Dry
- Hand Stripping
- Nail Clipping
- Ear Cleaning/Plucking
- No Holding Crates



20 Stretham Road, Wicken, Ely
Mobile: 07960 990593
Tel: 01353 624610

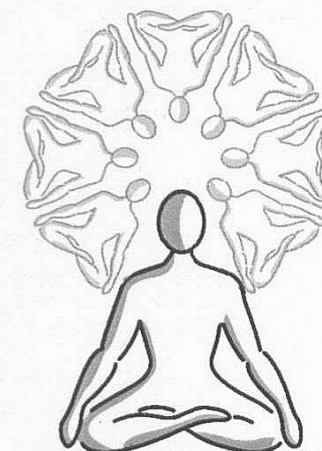

BRITISH WHEEL OF YOGA
TEACHER

Ely 721681 or
sophie.leek@btinternet.com

Make Your Garden More Hedgehog Friendly

1. Hedgehogs travel about a mile each night so need access to lots of gardens! Leave a 5in (13cm) square gap in boundary fences or walls.



2. Keep a corner of your garden wild to offer shelter, protection and natural food.

3. Provide fresh water in a shallow dish and food such as meat-based pet food for hedgehogs, especially during long dry spells.

4. Before strimming or mowing check areas thoroughly for hedgehogs and other wildlife.

5. Pesticides and slug pellets can harm hedgehogs and damage their food supply chain so try not to use them in your garden.

6. Bonfires make good homes for a hedgehog, please re-site the materials just before the fire is to be lit checking for wildlife and pets before lighting.

7. Dispose of litter responsibly. It can cause injury or starvation if hedgehogs get trapped in discarded rubbish.

Celebrate VE Day in Wicken, Padney & Upware!

Celebrate VE Day in Wicken and Upware!

Friday 8th May is a special bank holiday to celebrate VE Day. It's really unlikely that we'll be able to gather together in the current circumstances so we'd like to invite every household to take part in the celebration by decorating your house and garden by:

- ◇ Making bunting
- ◇ Making a big butterfly (inspired by the Wicken sign)



You can use pretty much anything you can get your hands on! We'll all need to be inventive but we can still celebrate the end of World War 2 !

If you need any more information see the Wicken website:

<http://wicken-village.org.uk/>

and the Facebook page:

[www.facebook.com](https://www.facebook.com/wickenparishcouncil) search for Wicken Parish Council (Cambridgeshire)

Jilly Rogers

Village Speeding

It's strange, so much quieter, almost eerie living on the main road to have a significant reduction in the volume of traffic, although this is not true of the number of lorries, if anything it seems there are more using the road as a cut through!

However more concerning is that the fewer vehicles the greater the speeding.

Having taken a regular daily walk over the past 2 weeks or so passing the flashing speed monitor at our end of the village, (coming in from Stretham), it would seem that 40 mph is now very the much new 30 mph.

It's now regular for vehicles to record speeds in the high 30's into the low 40's but then along came a 53 mph, a new record we thought but how wrong could we be the current highest now stands at 59 mph with not even a touch of the brakes as it passed the sign!!!!

What more can be done to educate drivers that these speed limits are there to protect the residents and our village environment.

Merrilyn